

## Teknisk data

### DESIGN

2 delad kulventil med fullt genomlopp.  
DVGW godkänd för gas upp till 2". Spindel  
TA-Luft godkänd.

### TESTER/GODKÄNNANDEN

DIN EN 13774:2003  
DVGW VP 303:1994

### REGISTRERINGSNUMMER

DG-4313BR5752

### FUNKTION

90°reglering genom handspak.

### ANSLUTNING

Invändig gänga 1/4" ... 3", DIN 2999,  
med DVGW-godkännande: 3/8" ... 2"  
Invändig/utvändig gänga vid förfrågan.

### TRYCKOMRÅDE

- PN40 ... PN100
- PN5  
för användning till gasdistribution  
enligt DVGW

### TEMPERATUROMRÅDE

-20°C ... +150°C

### OMGIVNINGSTEMPERATUR

-10°C ... +60°C

### MATERIAL

Hus: Rostfritt stål 1.4408  
Kula: Rostfritt stål 1.4401  
Tätning: PTFE  
Spindeltätning: FKM  
Handspak: Rostfritt 1.4301

## Specification

### DESIGN

Body consists of 2 parts, full bore. Up to 2"  
with DVGW approval for gas.  
Stem with acc. TA-Luft approval

### BASIS OF TYPE EXAMINATION

DIN EN 13774:2003  
DVGW VP 303:1994

### REGISTRATION NUMBER

DG-4313BR5752

### OPERATION

Rotation of the handle through 90°.

### CONNECTION

Female thread 1/4" ... 3", DIN 2999,  
with DVGW approval: 3/8" ... 2"  
Female-/male thread on request.

### PRESSURE RANGE

- PN40 ... PN100
- PN5  
by using for gas distribution  
acc. to DVGW

### TEMPERATURE RANGE

-20°C ... +150°C

### AMBIENT TEMPERATURE RANGE

-10°C ... +60°C

### MATERIALS

Body: Stainless steel 1.4408  
Ball: Stainless steel 1.4401  
Ball seal: PTFE  
Stem seal: FKM  
Handle: Stainless steel 1.4301

The above information is intended for guid-  
ance only and the company reserves the  
right to change any data herein without prior  
notice!

Artikel:  
**EK**

2 delad kulventil  
PN40 ... PN100

Rostfritt stål 1.4408

DIN-DVGW



Type:  
**EK**

2-way ball valve  
PN40 ... PN100

Stainless steel

DIN-DVGW



## Förklaring artikelnummer: T.ex. EK 311625

= 2 delad kulventil, DVGW-version, fullt genomlopp, rostfritt stål/ PTFE-FKM-NBR/rostfritt stål, med handspak, 1" invändig gänga

Siffror 1.+ 2. Produkt	Siffror 3.+ 4. Material Hus / Tätning / Kula	Siffror 5. Manöver/reglering	Siffror 6. Alternativ	Siffror 7.+ 8. Anslutning (enligt DIN 2999)
EK = 2 delad kulventil	31 = Rostfritt stål/ PTFE-FKM / rostfritt stål	1 = Handspak	6 = DIN-DVGW (upp till 2")	21 = 1/4 22 = 3/8 23 = 1/2 24 = 3/4 25 = 1 26 = 1 1/4 27 = 1 1/2 28 = 2 29 = 2 1/2 30 = 3

## Ordering example: e.g. EK311625

= 2-way ball-valve, DVGW-version, full bore, stainless steel / PTFE-FKM-NBR / stainless steel, with handle, female thread: 1"

1.+ 2. Digit Product	3.+ 4. Digit Material Body / Seal / Ball	5. Digit Operation	6. Digit Options	7.+ 8. Digit Connection size (acc. to DIN 2999)
EK = 2-way ball-valve,	31 = stainless steel / PTFE-FKM / stainless steel	1 = lever handle	6 = DIN-DVGW (up to max. 2")	21 = 1/4 22 = 3/8 23 = 1/2 24 = 3/4 25 = 1 26 = 1 1/4 27 = 1 1/2 28 = 2 29 = 2 1/2 30 = 3

## Tryck-Temperatur-diagram / Pressure-Temperature-Diagram

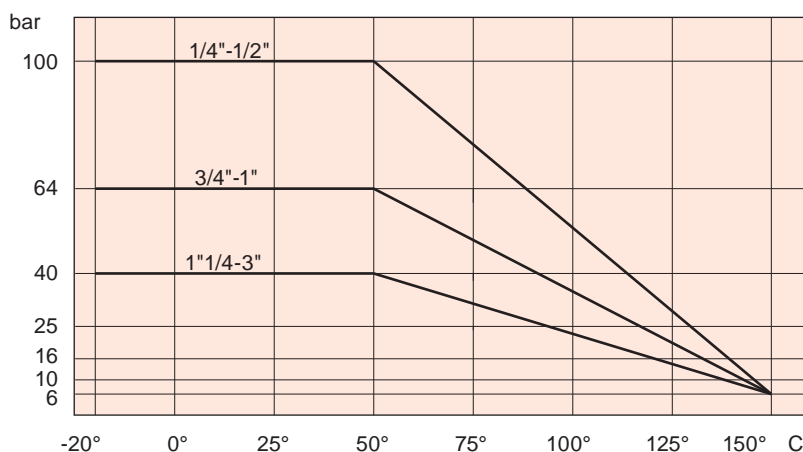

## Flödesschema / Flow rate - Loss of head

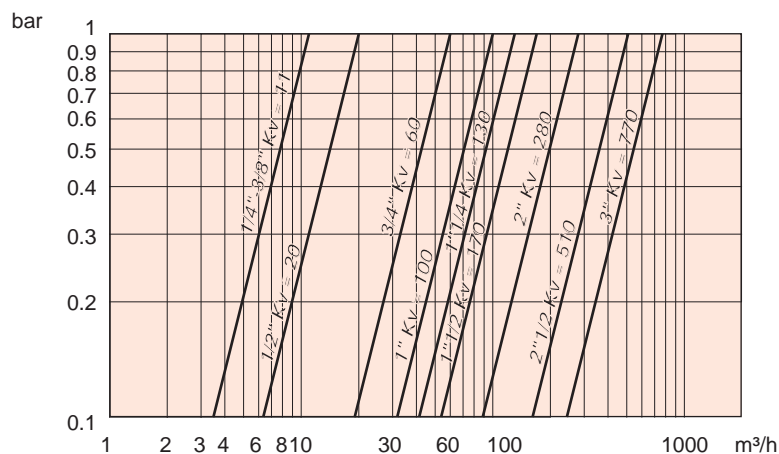

## Sprängskiss / Parts list

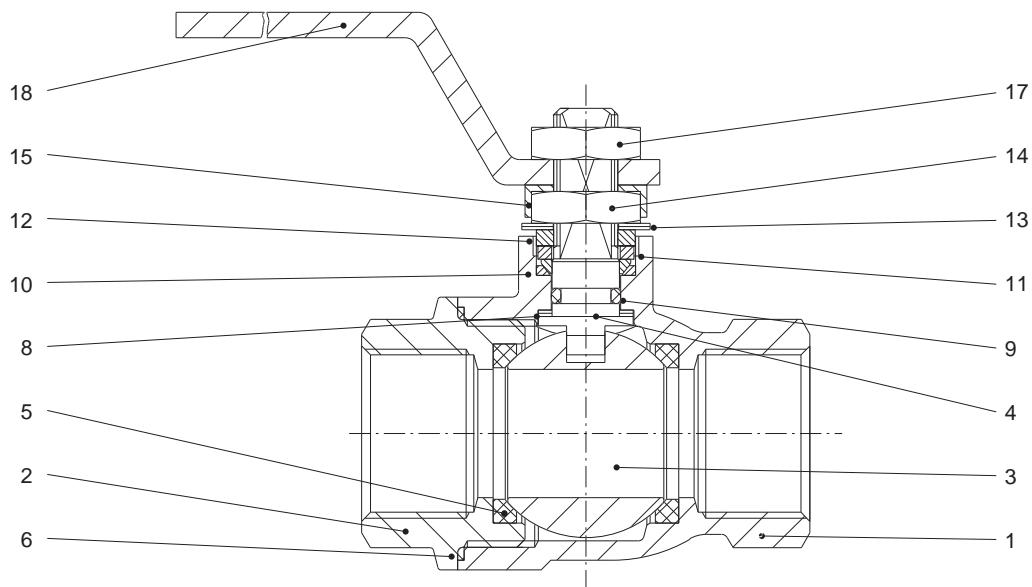

Pos.	Benämning	Description	Material	Material
1	Hus	Body	Rostfritt stål 1.4408	Stainless steel 1.4408
2	Anslutning	Connection end	Rostfritt stål 1.4408	Stainless steel 1.4408
3	Kula	Ball	Rostfritt stål 1.4401	Stainless steel 1.4401
4	Spindel	Stem	Rostfritt stål 1.4401	Stainless steel 1.4401
5	Kultätning	Ball seals	PTFE	PTFE
6	Tätning hus	Side sealing	PTFE	PTFE
8	Övre tätningsring	Upper sealing ring	PTFE	PTFE
9	O-ring	O-ring	FKM	FKM
10	Spindeltätning	Upper sealing couple	PTFE	PTFE
11	Glandtätning	Packing gland	Rostfritt stål 1.4301	Stainless steel 1.4301
12	Ändstopp	Operation stop	Rostfritt stål 1.4301	Stainless steel 1.4301
13	Fjäderbrickor	Spring washers	Rostfritt stål 1.4310	Stainless steel 1.4310
14	Spindelmutter	Stem retaining nut	Rostfritt stål 1.4301	Stainless steel 1.4301
15	Låsbleck	Fixing nut plate	Rostfritt stål 1.4301	Stainless steel 1.4301
17	Mutter	Nut	Rostfritt stål 1.4301	Stainless steel 1.4301
18	Handspak	Handle	Rostfritt stål 1.4301	Stainless steel 1.4301

## Moment [Nm] / Breakaway torques [Nm]

		Storlek / size									
		1/4	3/8	1/2	3/4	1	1 1/4	1 1/2	2	2 1/2	3
PN [bar]	0	1,6	1,6	3,2	3,6	4,6	11,5	19,0	27,5	65,0	78,0
	16	1,8	1,8	4,3	4,9	5,9	15,0	24,0	38,0	74,0	87,0
	40	2,5	2,5	5,1	6,0	6,9	16,7	28,6	42,0	84,0	97,0
	64	3,2	3,2	5,6	6,8	8,0					
	100	3,8	3,8	6,5							

### Information

Produkterna som beskrivs i denna dokumentation är i den form de levereras inga maskiner enligt bilaga 2 punkt a och inga delvis färdigställda maskiner enligt bilaga 2 punkt g i maskindirektivet 2006/42/EG.

### Advice

The products described in this documentation in the conditions of our delivery are no machinery according to annex 2 paragraph a respectively no partly completed machinery according to annex 2 paragraph g of the directive 2006/42/EC on machinery.



## Dimensioner / Dimension

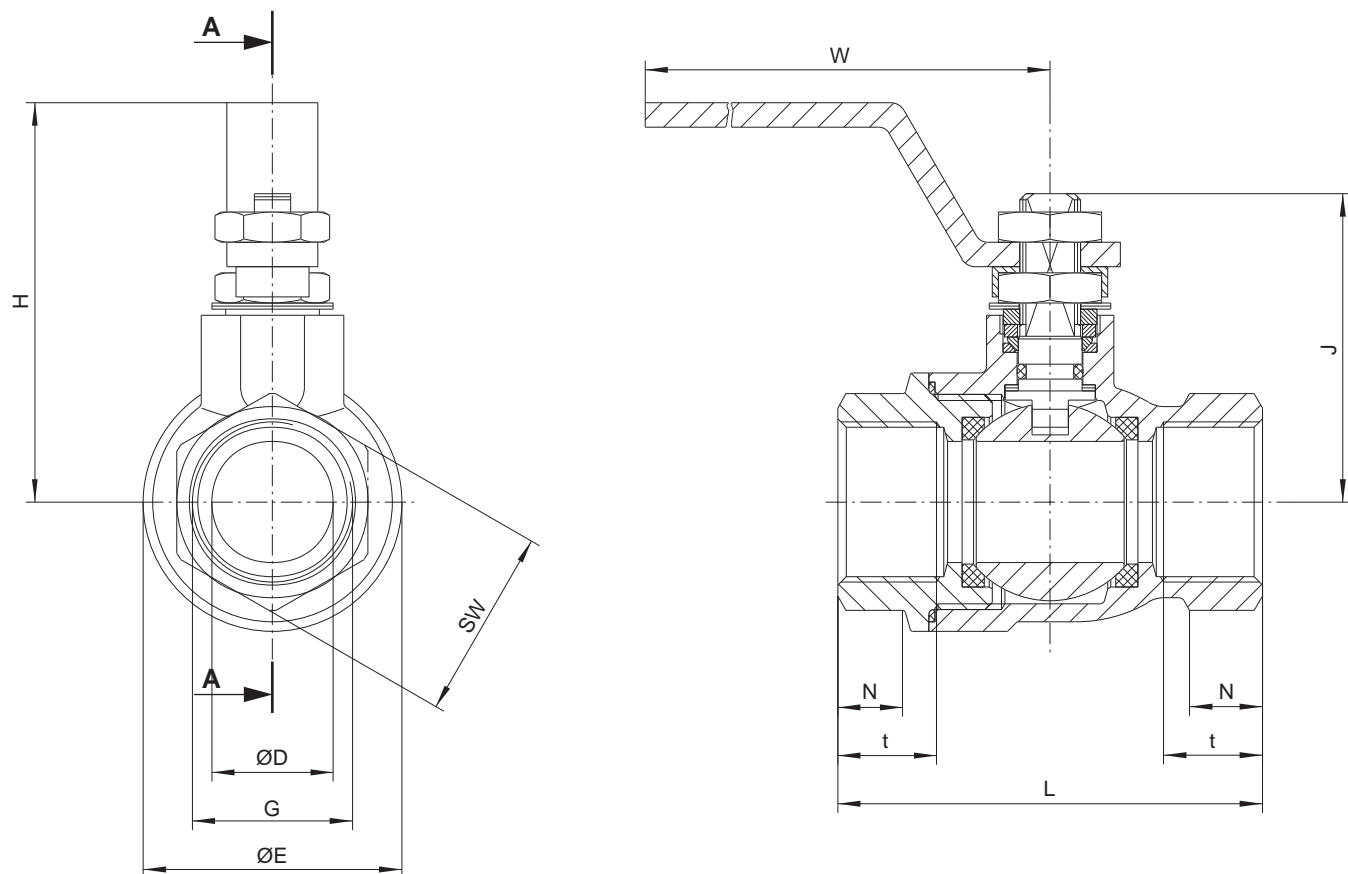

G	H	ØD	ØE	W	J	N	t	L	SW	kg	PN
1/4"	52	8	29	110	37	8,5	11,4	55	21,5	0,220	100
3/8"	52	10	29	110	37	8,5	11,4	55	21,5	0,205	100
1/2"	55	15	34	110	42	10	15	65	26,5	0,275	100
3/4"	66	20	42,5	140	52	11,5	16,3	70	31,5	0,465	64
1"	70	25	50,5	140	56	14	19,1	85	40,5	0,710	64
1 1/4"	85	32	63	180	68	15,5	21,4	95	49,5	1,180	40
1 1/2"	91	40	75,5	180	74	18,5	21,4	105	54,5	1,740	40
2"	105	50	91	230	87	22,5	25,7	125	69,5	2,930	40
2 1/2"	133	65	118	247	101	27	32,5	167	86	6,200	40
3"	143	76	139	247	110	27	32,5	192	101	9,000	40

Svensk översättning 230111 - AVK Sverige AB/INDVA

Art. EK - Sida 4/4



END-Armaturen GmbH & Co. KG

Postfach (PLZ 32503) 100 341 · Oberbeckener Str. 78 · D-32547 Bad Oeynhausen (Germany) · Telefon +49 - 5731 - 7900-0 · Telefax +49 - 5731 - 7900-199 · <http://www.end.de>

Dok.-Nr.: KAT-EK-4/4 - 03.2013 - Änderung: Baulängen