



AVK REDUCER FLANGE

712/3550-001

PN 10/16



AVK's range of fittings comprises a wide selection of variants with socket and flange connection. The fittings are made of ductile iron GJS-500-7 and are epoxy coated according to DIN 3476-1 and GSK specifications - internally and externally.



Product description:

Double reducer flange type XR to EN 545 for water, waste water and neutral liquids to max. 70° C

Design standards:

- EN 545
- Flange drilling to EN1092, PN10/16

Features:

- Ductile iron fitting to EN 545
- Body of GJS-500-7
- Fusion bonded epoxy coating to DIN 3476-1 and EN 14901, GSK approved
- Bolts of Zinc coated steel 8.8 as standard, optionally of stainless steel A2 or A4

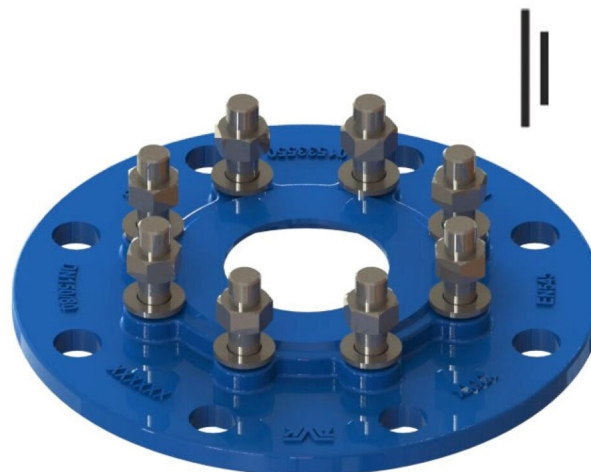

Expect... **AVK**

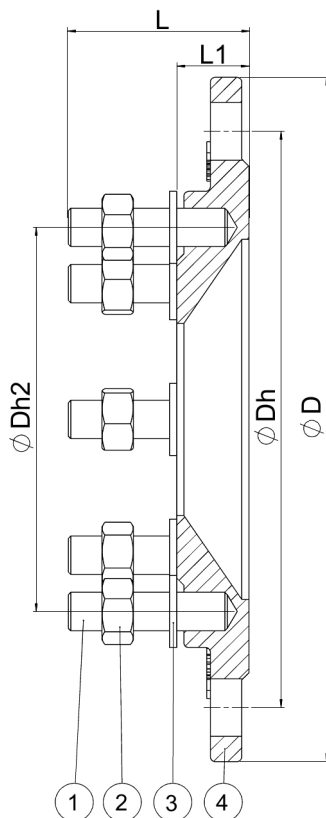

Component list:

1. Stud bolt	Steel, hot dip galvanized	3. Washer	Steel, hot dip galvanized
2. Nut	Steel, hot dip galvanized	4. Body	Ductile Iron

Components may be substituted with equivalent or higher class materials without prior notification.

Reference nos. and dimensions:

AVK ref. no.	DN/DN	PN Class	D mm	Dh mm	Dh2 mm	L mm	L1 mm	Theoretical weight/kg
712-0104-35-501060	40 - 100	PN 10/16	220	180	110	78	30	7.1
712-0153-35-501060	150 - 80	PN 10/16	285	240	160	78	30	7.1
712-0154-35-501060	65 - 150	PN 10/16	285	240	145	86	35	7.3
712-0157-35-501060	60 - 150	PN 10/16	285	240	135	84	33	7.1
712-0202-35-500060	125 - 200	PN10	340	295	210	87	30	7.1
712-0203-35-500060	200 - 100	PN10	340	295	180	84	33	7.1
712-0203-35-501060	100 - 200	PN16	340	295	180	84	33	13
712-0204-35-500060	80 - 200	PN10	340	295	160	84	33	13
712-0204-35-501060	80 - 200	PN16	340	295	160	84	33	13
712-0205-35-501060	65 - 200	PN16	340	295	145	84	33	14
712-0210-35-500060	60 - 200	PN10	340	295	135	89	33	13
712-0252-35-500060	250 - 150	PN10	405	350	240	103	40	7.1
712-0252-35-501060	150 - 250	PN16	405	355	240	103	40	7.1
712-0254-35-501060	100 - 250	PN16	405	355	180	92	41	22
712-0302-35-500060	300 - 200	PN10	460	400	295	106	40	17
712-0302-35-501060	200 - 300	PN16	460	410	295	106	40	17
712-0303-35-500060	300 - 150	PN10	460	400	240	102	40	30
712-0404-35-501060	200 - 400	PN16	580	525	295	110	48	39