



AVK LARGE COMBINATION AIR VALVE, PN16

701/78-010

For wastewater, steel

AVK combination air valves are designed to combine large volume of air discharge/intake whilst filling/draining a pipeline with automatic discharge of air from the fluid. They feature an innovative design with a large air gap between liquid and sealing system. A spring between stem and float compensates for slight pressure changes and maintains the air gap ensuring reliable function even when used with aggressive liquids and liquids carrying solid particles.

Product description:

Large combination air valve for wastewater treatment to max. 60°C (temporarily up to 90°C)

Test/Approvals:

- Hydraulic test according to EN 1074-1 and 4 / EN 12266
- Approved for wastewater

Features:

- Orifice sizes: Automatic 16 mm², kinetic 5024 mm².
- The large air gap between liquid and sealing system ensures a reliable function even when used with aggressive liquids and liquids carrying solid particles.
- The small orifice in the automatic valve releases small volumes of air when the line is under pressure. The spring between the stem and upper float compensates for slight pressure changes.
- Unique design of the float assembly prevents contact between the wastewater and the sealing mechanism, prevents clogging by floating solids and ensures drip-tight sealing.
- The disc is placed at the top of the valve, keeping the levers and pins away from the corrosive atmosphere in the air valve body.
- The stainless steel float system ensures high corrosion resistance.
- The conical body with funnel-shaped lower body allows maximum air volume within minimum valve length and prevents accumulation of deposits at the bottom.
- The spray guard minimizes liquid spray discharge from the air valve outlet, mainly during rapid pipeline filling conditions.
- The epoxy coated steel body features low weight.
- Drainage and flushing is possible through the drain in the valve's side.
- An exhaust tube can be mounted in the threaded opening on the top of the valve.
- The outlet enables removal of excessive fluids.
- With connection flange.
- Working pressure range: 0.2 – 16 bar.



Expect... **AVR**

AVK LARGE COMBINATION AIR VALVE, PN16

701/78-010

For wastewater, steel

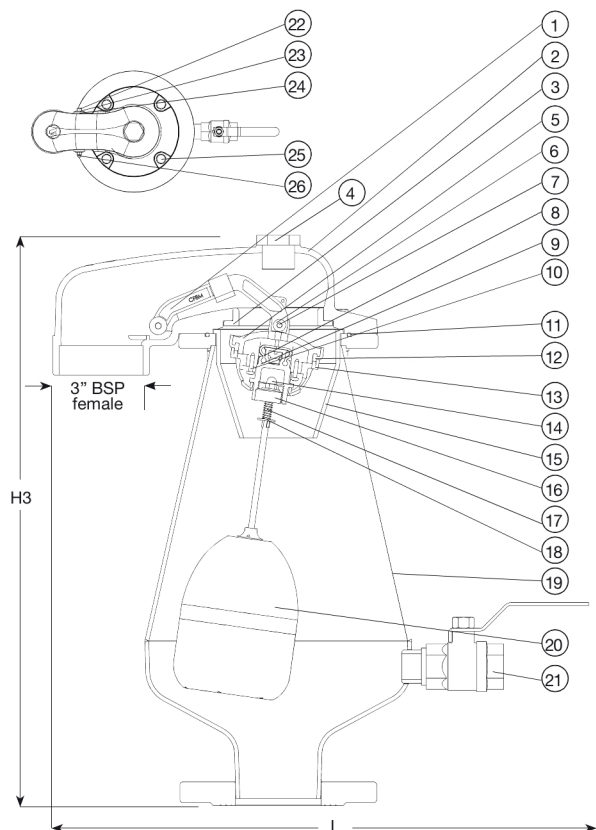

AUTOMATIC AIR RELEASE FLOW RATE

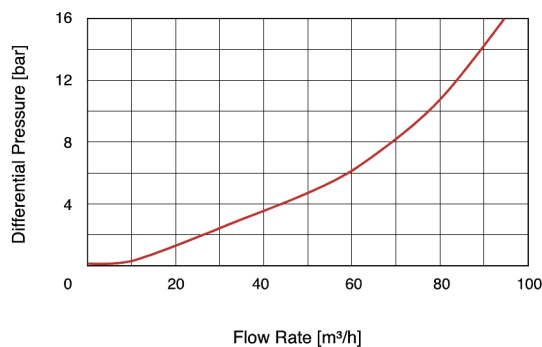

Air and vacuum flow rate

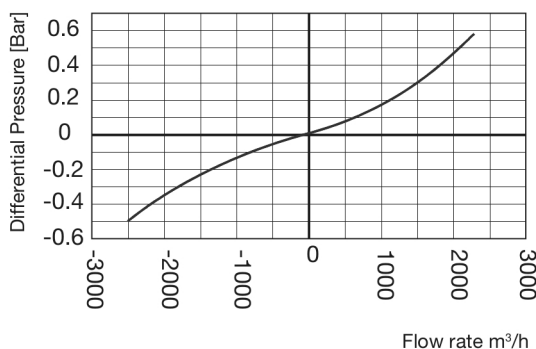

Component list:

1. Disc arm assembly	Stainless steel, cast	14. Domed nut / washer	Stainless steel AISI 304
2. Cover	Ductile Iron	15. Spray guard	PP
3. Orifice seat	Stainless steel AISI 316	16. Stopper	PP
4. Plug	PP	17. Spring	Stainless steel AISI 316
5. Air and vacuum disc	PA/SS	18. Washer	Stainless steel AISI 304
6. Washer	Stainless steel AISI 304	19. Body	Steel
7. Rivet	Stainless steel AISI 304	20. Float assembly	Stainless steel AISI 316
8. Air release seal	EPDM rubber	21. Ball valve	Stainless steel 1.4401 (316)
9. Air release disc	PA, reinforced	22. Bolt	Stainless steel AISI 316
10. Bolt	Stainless steel AISI 304	23. Washer	Stainless steel AISI 316
11. O-ring	NBR rubber	24. Bushing	POM
12. Air and vacuum seal	EPDM rubber	25. Bolt/nut/washer	Stainless steel AISI 316
13. Air and vacuum seal lock	PA, reinforced	26. Domed nut	Stainless steel AISI 316

Components may be substituted with equivalent or higher class materials without prior notification.

Reference nos. and dimensions:

AVK ref. no.	DN	Flange	L	H3	Theoretical weight/kg
	mm	drilling	mm	mm	
701-080-78-11003	80	PN10/16	554	580	25
701-100-78-11003	100	PN10/16	554	580	27
701-150-78-11003	150	PN10/16	554	580	28
701-200-78-01003	200	PN10	554	580	30
701-200-78-11003	200	PN16	554	580	30

The designs, materials and specifications shown are subject to change without notice due to the continuous development of our product range.