



COMBINATION AIR VALVE

SERIES 701/50

1. INSTALLATION AND OPERATION

1. Mount the air valve on a riser connected to the crown of the pipe.
2. Install an isolating valve underneath the air valve.
3. Flush the system before installing the air valve to avoid any dirt or sharp objects penetrating the air valve.
4. Lift the air valve and place it carefully on the rubber gaskets of the shut-off valve.
5. Place washers on each of the bolts & nuts that connect the air valve flange to the shut-off valve flange.
6. Tighten all the bolts and nuts by closing them using the crossover method. The torque of the bolts and nuts shall be according to the standard torque for their specific size.
7. Vent/drainage pipe: If a vent pipe is required, the diameter of the pipe must be equal or bigger than the size of the air valve outlet. The pipe must not be collapsible and the outlet side of the drainage pipe must always be open to atmosphere.



2. MARKING



Label:

- Manufacturer
- EAN number in clear text and as bar code
- Item number
- Product specification
- Year of production
- Internal order number
- Unique serial number in clear text and as bar code

3. MAINTENANCE

1. Automatic air valve

- 1.1. Shut the isolating valve below the air valve.
- 1.2. Unscrew the body (1) of the automatic air release valve from the base (7). Make sure that the base does not rotate.
- 1.3. Remove the clamping stem (5) and the float (4) from the body.
- 1.4. Wash the inside of the body, the clamping stem, the float and the rolling seal (3) under clean running water.
- 1.5. Make sure the rolling seal is not damaged (torn or cracked) and is situated precisely in the middle of its groove in the float. Replace the rolling seal if it is damaged or has been removed from the float.
- 1.6. Reassemble the air valve in reverse order: First insert half the length of the rolling seal into the groove in the body, and then push it in place with the aid of the clamping stem. Make sure that the rolling seal is set and held in place.

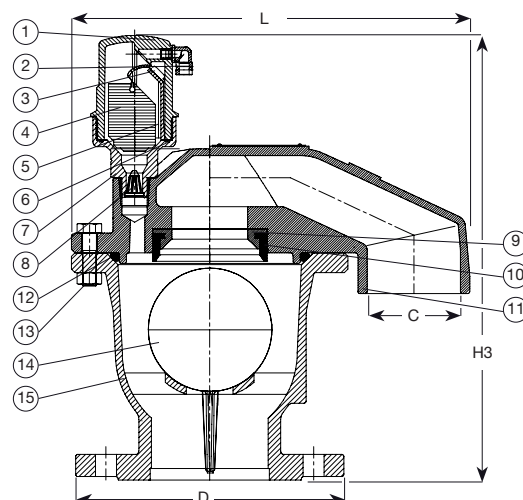

COMBINATION AIR VALVE

SERIES 701/50

2. Kinetic air valve

- 2.1. Unscrew the bolts (13) that connect the cover (11) to the body (15).
- 2.2. Wash and clean the body including the groove of the O-ring (12), the float (14) and the cover including the orifice seat (9), orifice seal (10) and the attached base (7) with the strainer (8) under clean running water
- 2.3. Check that the orifice seal is not damaged (torn and/or cracked).
- 2.4. In case the orifice seal is damaged, consult AVK.
- 2.5. Reassemble the air valve in reverse order:
 First insert the float, and then place the O-ring in the groove.
 Place the cover on the body, insert the bolts and washers (13) and tighten the nuts (13).
- 2.6. Tighten all the bolts and nuts using the crossover method.
 The torque of the bolts and nuts shall be according to the standard torque for their specific size.

4. PARTS LIST

1. Body
2. Discharge outlet
3. Rolling seal
4. Float
5. Clamping stem
6. O-ring
7. Base
8. Strainer
9. Orifice seat
10. Orifice seal
11. Cover
12. O-ring
13. Bolt, nut & washer
14. Float
15. Body

